

W3W /// ideals.dwell.airliners

Grid Ref: 381069, 267781

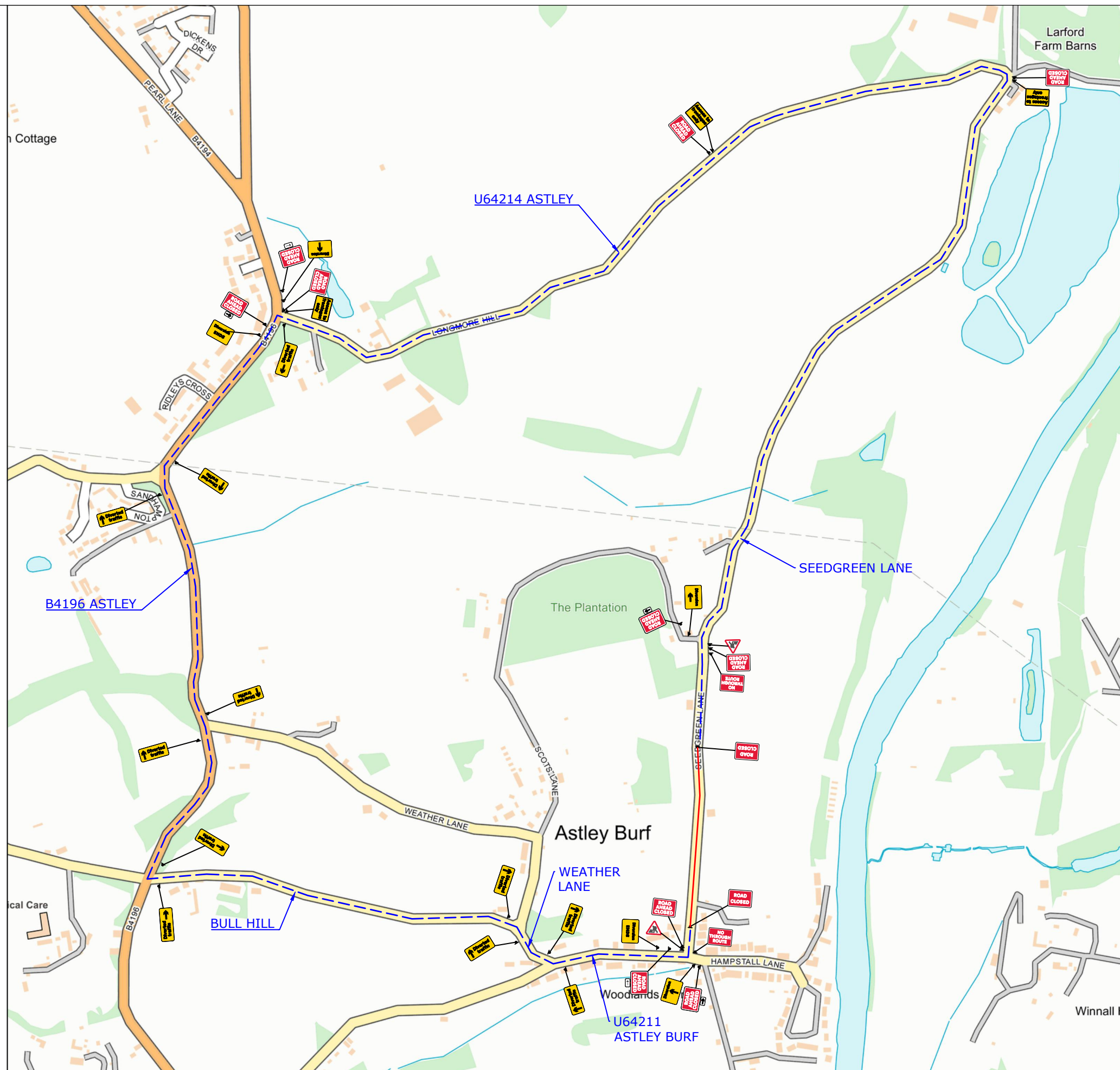

ADVANCED WARNING

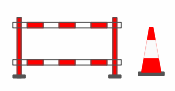

ROAD CLOSURE

DIVERSION ROUTE

ROAD CLOSURE LENGTH	305 METRES
---------------------	------------

ROAD CLOSURE WIDTH	3.5 METRES
--------------------	------------

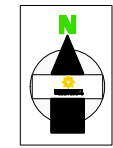

Contract No	254-S016715
Date	17/04/2026
Drawn by	SG/864
Approved By	xx
Purpose of works	TELECOM WORKS
Version Number	01
Amended By	xx
Amendment Date	xx
Sheet No	1 of 1

Client: OPENREACH	
Site Location / Drawing Title	
DP1223 SEEDGREEN LANE	
ASTLEY BURF	
STOURPORT DY13 OSA	
Scale	NOT TO SCALE
OS Licence No	000000000000

Note  
 1. All equipment shall be approved and shall comply with the Department Of Transport specification MCE0111. This drawing does not show the normal road works signage that will be required as per Chapter 8.  
 2. All signs to be in accordance with TSRGD 2016 and to minimum class retroreflective.  
 3. Minimum height of lettering to be 60mm and sign boards to be 1000mm (750mm where appropriate).

TO BE INSTALLED AT CLOSURE POINTS

**THIS DOCUMENT IS UNCONTROLLED WHEN PRINTED**  
 The electronic version of this document is the approved and most current. Any printed version is uncontrolled and may not be current.

DETAIL AL (AL)  
 Manned Airlock system.  
 Notes:  
 1) Minimal site traffic 25 - 30m air lock is sufficient; Extend airlock for larger work vehicle flow.  
 2) Red lamps to be used on Nissen Barrier (all HE networks)

**SUNBELT RENTALS**  
 Sunbelt Rentals UK (Traffic Management)  
 Kemble Airfield Enterprise Park, Cirencester Road,  
 Kemble GL7 6BQ  
 Telephone: 0370 050 0792